



Body shop lift

RAV.KBI30.199997

GTIN: 5063084199997

SKU: RAV.KBI30.199997

3.0 t, electrohydraulic, ATEX compliant according to Directive 2014/34/EU, with pneumatic operated arms and TEq-Link, inground

DESCRIPTION

Scissor lift ideal for installation in both paint booth grids and preparation areas, and flush-mounted for traditional floors. Its ergonomic design allows you to easily reach the pick-up points of the vehicles, eliminating all obstacles surrounding the vehicle, in this way making every operation on the chassis easier.

- Wide range of loadability: suitable for every type of vehicle
- Quick to use: pad built into the arm that reduces the number of operations necessary for lifting the vehicle
- Flexible installation: simple and fast installation with minimum interventions, even when there are grids
- The geometry of the arms was designed for lifting the entire fleet of cars on the road, from microcars to long wheel base sedan.
- Pad always on: The arms have a built-in pad so they can always remain on the lift, even in the rest position. The lift is ready-to-use without requiring the operator to perform any other work.
- The lift can be installed without any additional shim in grids 270 to 370 mm deep.
- Changing the standard intake grille is unnecessary. All you have to do is remove the grids for a 2000 x 700 mm surface area.
- Configurations available: A wide range of configurations is available to satisfy all types of work cycle in the body shop.
- Compatible with system TEq-Link
 - Internet connection
 - Sending results to the customers
 - Remote assistance
- There are no live components in the work area with the anti-explosion configuration meeting Directive 2014/34/EU. Ideal also for being used inside paint booths. The compact electrical panel is directly installed in the

workstation.

- Maximum ergonomics for all types of cars
- Elevated lifting height for working standing straight
- The safety of the operations is guaranteed by the automatic arm locking system and the mechanical safety on the cylinder. (Patent pending)

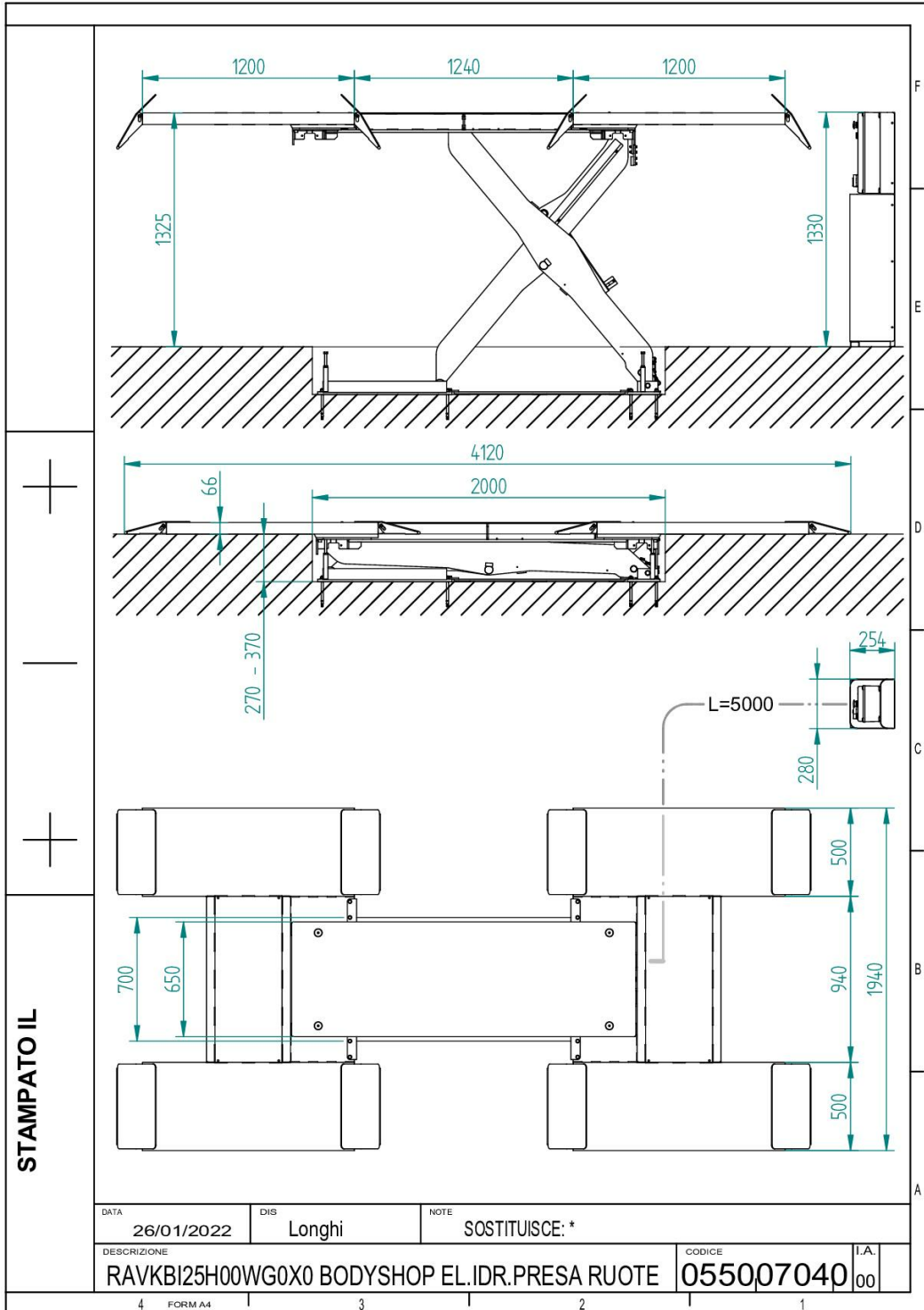

ACCESSORIES**Connection template**

VSG.KBIAC.900005

For front/back base connection |
necessary for lift installation

TECHNICAL DETAILS

Scissor lift design	Low-rise scissors
TeqLink	Standard
Mode of drive	Electrohydraulic
Type of installation	Surface mounted
Capacity	3000kg
Max. lifting height	1623mm
Max. lifting height at floor level	1353mm
Lifting time	40s
Lifting time loaded	40s
Lowering time	35s
Lowering time loaded	50s
Play detector	Not possible
Surface coating	Powder coated
Wheel alignment	Not possible
Length of platforms	1950mm
Width of platforms	650mm
Arm layout	Pneumatic
Wheel free lift	Not possible
Driving power	2,6kW
Electrical connection	400 V, 50 Hz
Air supply	7 - 8bar
Max. air supply	8bar
Length	1950mm
Width	650mm

Installation depth 270 - 370mm

Country of Origin, customs IT