



Body shop lift **RAV.KBI30.199812**

GTIN: 5063084199812

SKU: RAV.KBI30.199812

3.0 t, electrohydraulic, with manual arms, inground

DESCRIPTION

Scissor lift ideal for installation in both paint booth grids and preparation areas, and flush-mounted for traditional floors. Its ergonomic design allows you to easily reach the pick-up points of the vehicles, eliminating all obstacles surrounding the vehicle, in this way making every operation on the chassis easier.

- Wide range of loadability: suitable for every type of vehicle
- Quick to use: pad built into the arm that reduces the number of operations necessary for lifting the vehicle
- Flexible installation: simple and fast installation with minimum interventions, even when there are grids

- The geometry of the arms was designed for lifting the entire fleet of cars on the road, from microcars to long wheel base sedan.
- Pad always on: The arms have a built-in pad so they can always remain on the lift, even in the rest position. The lift is ready-to-use without requiring the operator to perform any other work.
- The lift can be installed without any additional shim in grids 270 to 370 mm deep.
- Changing the standard intake grille is unnecessary. All you have to do is remove the grids for a 2000 x 700 mm surface area.
- Configurations available: A wide range of configurations is available to satisfy all types of work cycle in the body shop.
- Hydraulic propulsion makes lifting fast without the “shaking” effect. Extremely less lifting time compared to the hydropneumatic version.

- Maximum ergonomics for all types of cars
- Elevated lifting height for working standing straight
- The safety of the operations is guaranteed by the automatic arm locking system and the mechanical safety on the cylinder. (Patent pending)

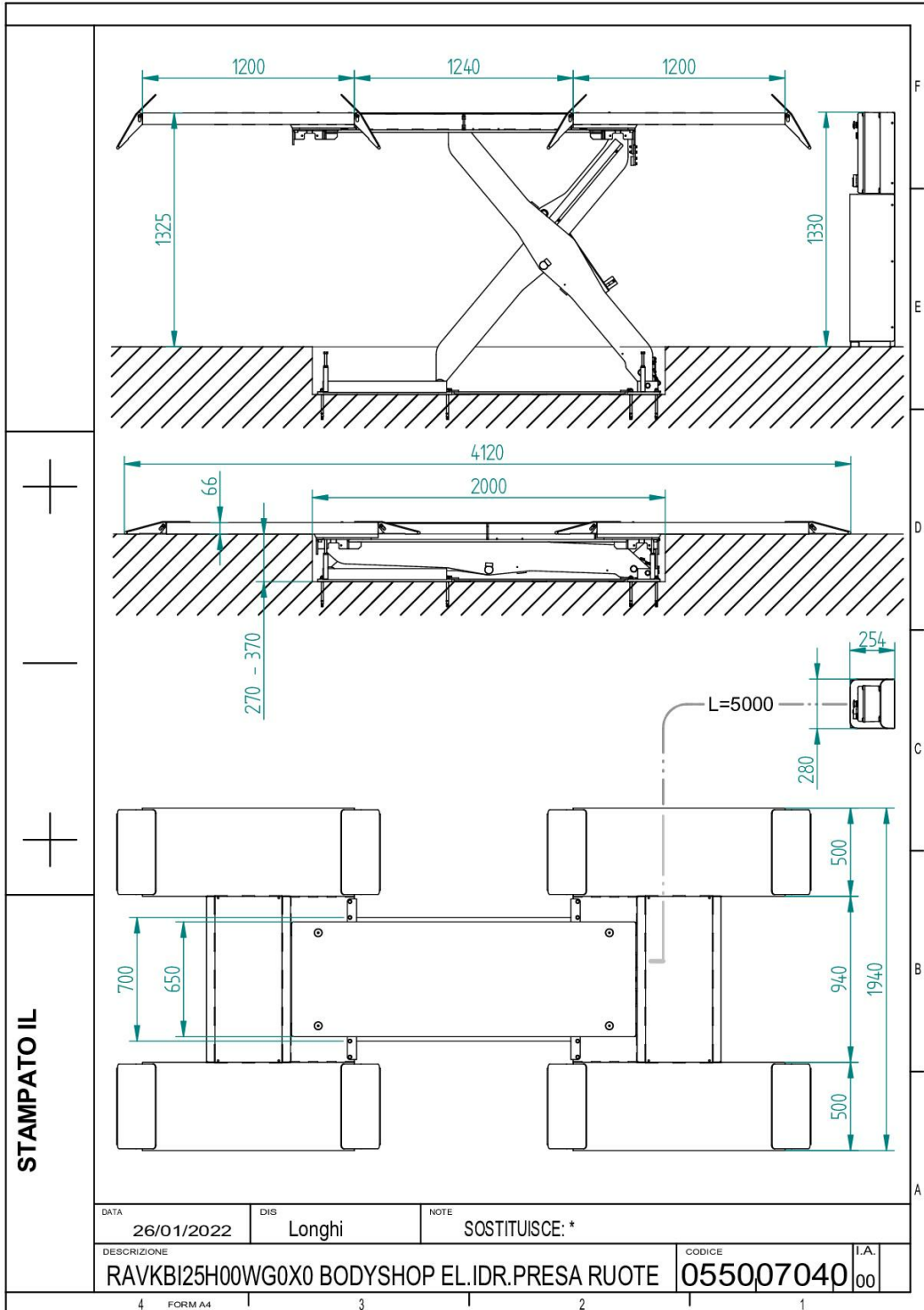

ACCESSORIES**Connection template**

VSG.KBIAC.900005

For front/back base connection |
necessary for lift installation

TECHNICAL DETAILS

Scissor lift design Low-rise scissors

Mode of drive Electrohydraulic

Type of installation Surface mounted

Capacity 3000kg

Max. lifting height 1623mm

Max. lifting height at floor level 1353mm

Lifting time 40s

Lifting time loaded 40s

Lowering time 35s

Lowering time loaded 50s

Play detector Not possible

Surface coating Powder coated

Wheel alignment Not possible

Length of platforms 1950mm

Width of platforms 650mm

Arm layout Manually

Wheel free lift Not possible

Driving power 2,6kW

Electrical connection 400 V, 50 Hz

Air supply 7 - 8bar

Max. air supply 8bar

Length 1950mm

Width 650mm

Installation depth 270 - 370mm

Country of Origin, customs IT