



2-post lift **KPH370.70LIKTA**

GTIN: 4057612814354

SKU: KPH370.70LIKTA

7.0 t, electrohydraulic, asymmetrical, supporting arms
4 x 3-piece

DESCRIPTION

Model ideal to lift long wheel-base vans. Model equipped with two long 3-stage arms and two long 4-stage arms, to allow easy lifting of large cars.

- Mechanical safety latch with automatic engagement ensuring maximum safety when lift is in standing position
- Synchronization cables grant the levelling of the two carriages
- Each column features a maintenance free lifting cylinder

- Adjustable height: 5016 - 4816 - 4616 mm

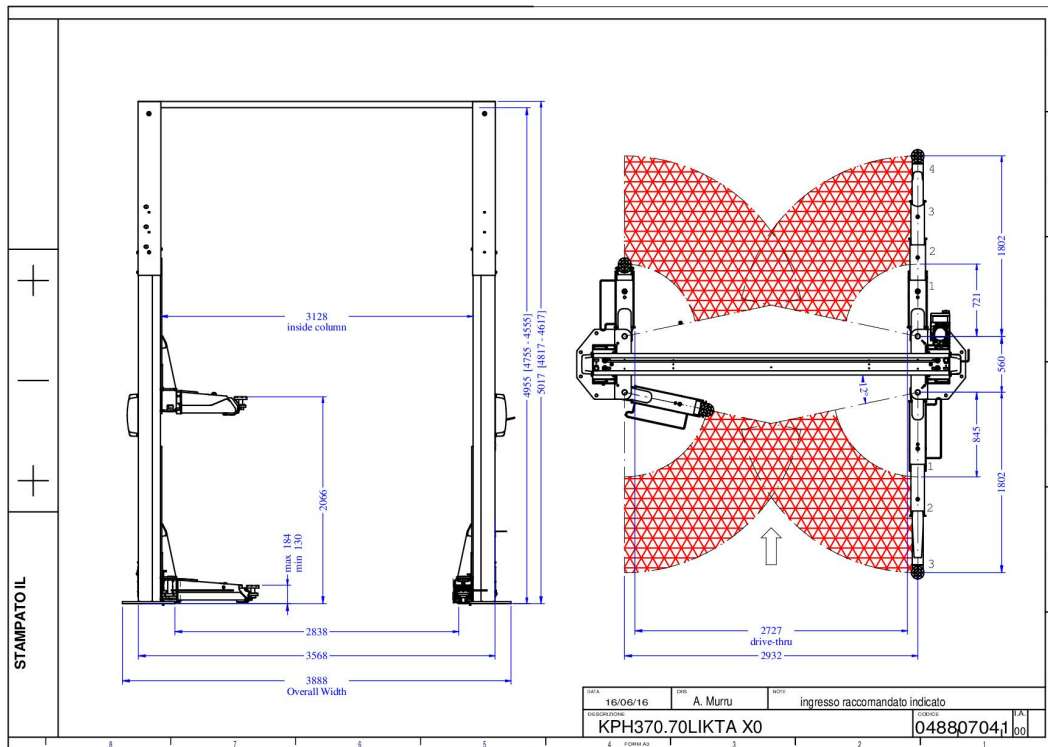

ACCESSORIES

Spacers 80 mm, bushing Ø 60 mm | 1 set / 4 pieces

S370A7



Spacers 140 mm, bushing Ø 60 mm | 1 set / 4 pieces

S370A8

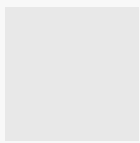

Product 199630

199630

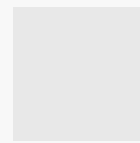

Product 200554

200554

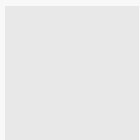

Product 200752

200752

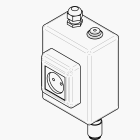

Energy kit for KPH370.xx

S374A2

Compressed air connection and 230 V socket | 1 piece



Limit switch | operated by bar | for 3-phase power supply | supplied not installed

S370A20

For all lifts with 3-phase power supply



Tool trays | magnetic | 1 set / 4 pieces

S370A27

TECHNICAL DETAILS

Number of columns	2
Capacity	7000kg
Mode of drive	Electrohydraulic
Control	Electric
Type of installation	Floor mounted
Max. lifting height	2066mm
Lifting time	70s
Min. plate height	130mm
Max. plate height	184mm
Clear span between	3128mm
Column height	5016mm
Drive-through width	2727mm
Required ceiling height	5120mm
Surface coating	Powder coated
Arm layout	Asymmetrical
Telescopic front arms	4-fold
Telescopic rear arms	3-fold
Min. front arm length	721mm
Max. front arm length	1802mm
Min. rear arm length	845mm
Max. rear arm length	1802mm
Driving power	3,5kW
Electrical connection	220 V, 60 Hz
Width	3888mm

Height	5017mm
---------------	--------

Max. height	5017mm
--------------------	--------